

## Gearbox actuator with integrated valves for Quaife QKE/QBM/QBE gearboxes

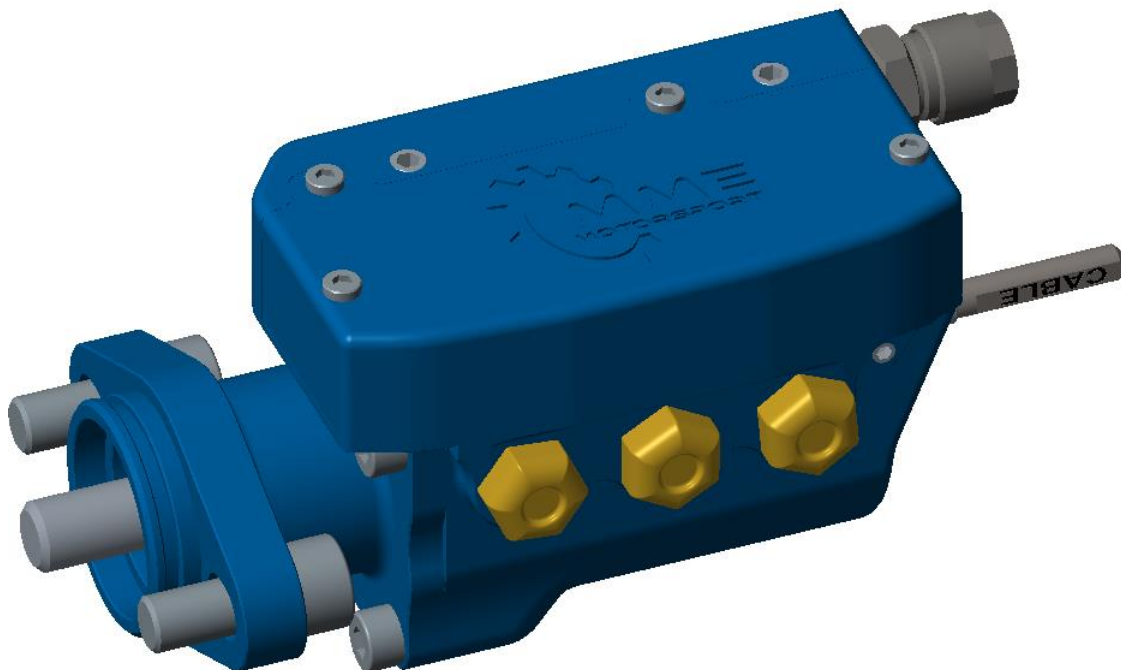

### Features

- Suitable for Quaife direct to gearbox mounting
- Supported gearboxes: QKE6V, QKE8J, QBE9J, QKE9D-H, QKE10J, QKE11E, QKE45Z, QBM2M, QBM6M, QBM7M, QBE46Z, QBE6U, QBE21C
- Powered by MME's Hypervelocity valves (Flow 900NI/min @ 8 bars)
- Two-way actuator (max +17mm / -17mm) with integrated valves
- No need for extra valve block
- Very light (only weights 630 g)
- 1005 N push and 915 pull force @ 8 bars

## Technical specifications

Dimensions L x W x H	177 x 57 x 65 mm		
Weight	630 g		
Operating temperature	-20 ... 80°C		
Operating pressure	6 ... 9 Bar		
Voltage	12 V		
Valve coil resistance	25 ohm		
Stroke	17+17 mm		
Operating force	Pressure[Bar]	Push [N]	Pull [N]
	6	750	685
	7	880	800
	8	1005	915
	9	1130	1030
Pneumatic fitting	Pneumatic tube 8/6 mm		

## Included in the kit

- ① Gearbox actuator with integrated valves  
Connector with pins

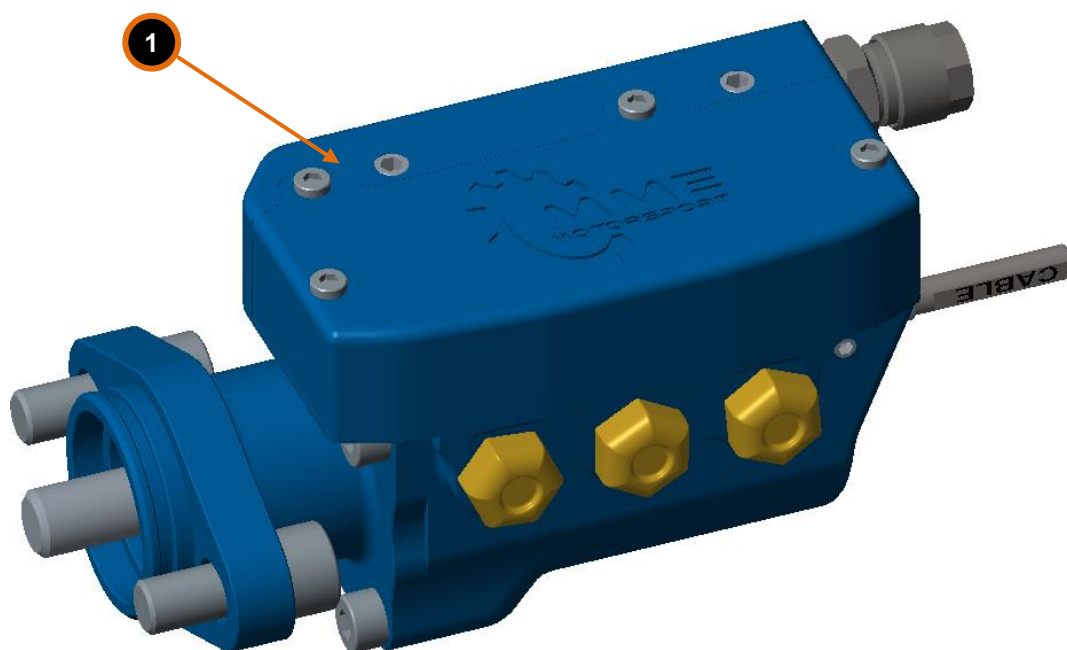

## Connection Diagram

- ② Air supply (Ø 8 mm pneumatic pipe).
- ③ Electrical cable with connector



## Mounting instruction

- ④ Disassemble your gear change rack cover and remove gear change rack.

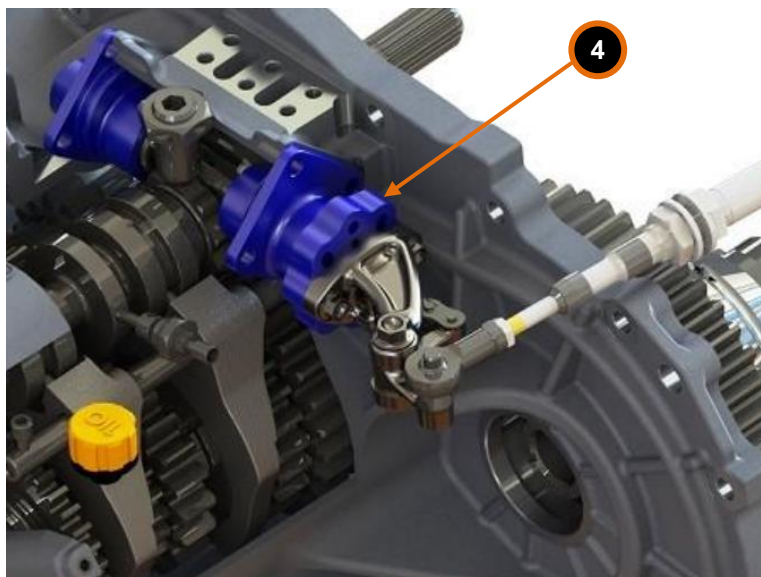

- ⑤ Remove the end of the rack and replace it with the gear actuator. Use high strength thread lock to screw piston rod of the gear actuator to the gear rack.

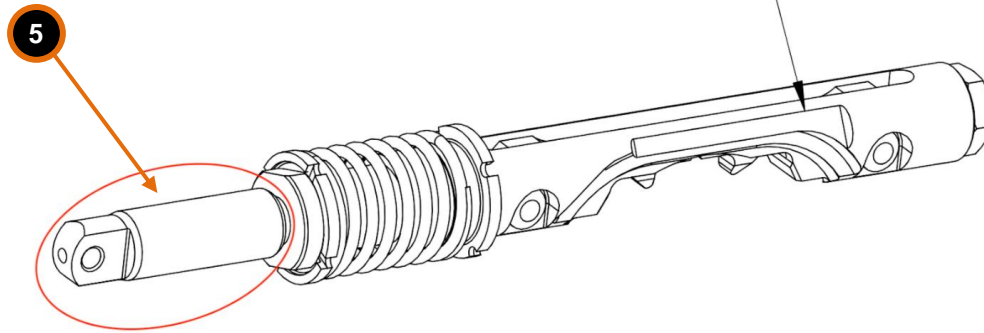

## Electrical diagram

Actuator is shipped with cable and pre-crimped epoxy glued 4 pin connector ATM04-4S. Mating connector is ATM04-4P or DTM04-4P. Mating pins are AT60-202-20141 or AT60-20-0122. AWM-4P 4-Way Wedgelock is also included.

Connector pinout

1	12V
2	OUT
3	IN
4	Not used

## Technical drawing

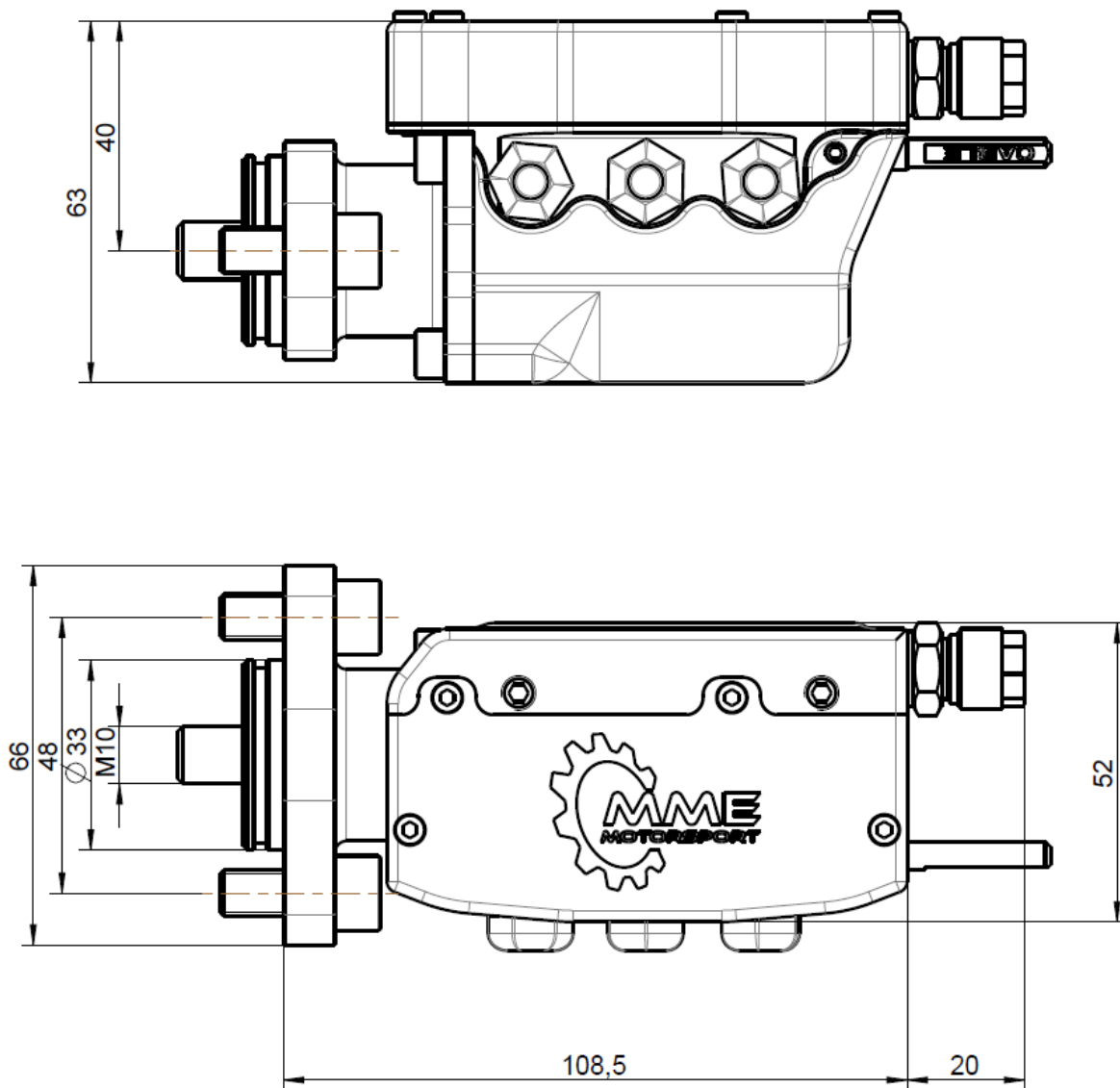

## Servicing

If there's any damage to the rod at any time, we recommend replacing the actuator.

Yearly inspection:

- Disassemble the actuator
- Check for any damage to the inside or outside of the actuator
- With piston rod removed, clean the inside and outside of the actuator with gasoline (Do not use Nitroglycerin).
- Seals, bushing and internal cylinder bore should be lubricated with FESTO grease LUB-KB1-SILIKONFREI.